

**INSIDE CORNER**

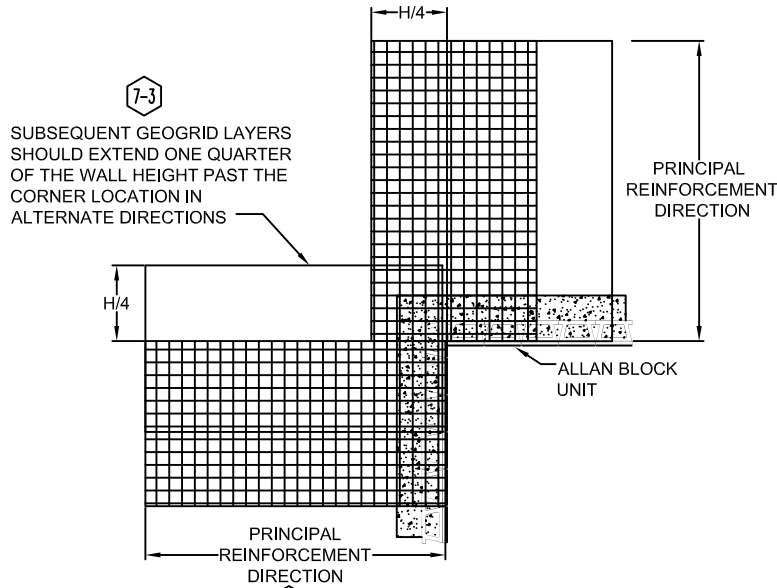

**OUTSIDE CORNER**

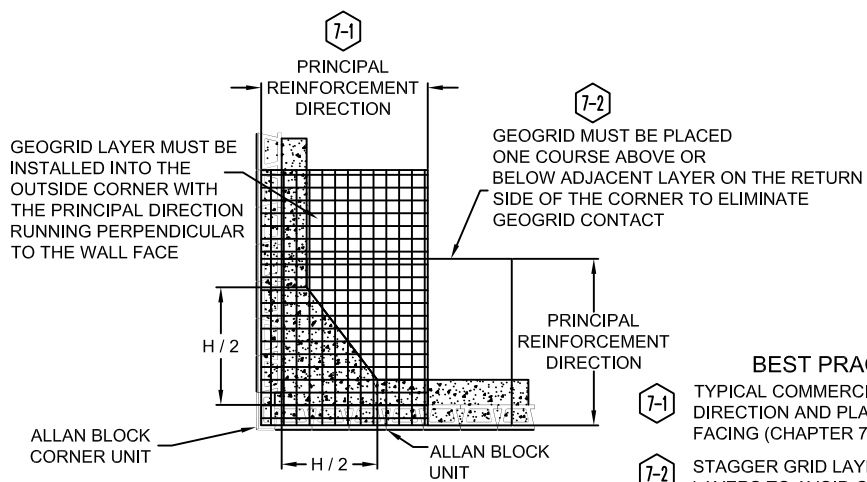

**BEST PRACTICES NOTES:**

- 7-1 TYPICAL COMMERCIAL GRID IS STRONG IN THE ROLL DIRECTION AND PLACED PERPENDICULAR TO THE WALL FACING (CHAPTER 7.2)
  - 7-2 STAGGER GRID LAYERS ON ALTERNATE SIDES, WEAVING LAYERS TO AVOID OVERLAP (CHAPTER 7.2)
  - 7-3 EXTEND GEOGRID LAYER INTO THE CORNER FROM ONE SIDE EQUAL TO 25% OF TOTAL WALL HEIGHT (CHAPTER 7.2)
  - 7-4 WHERE GRID TAILS OVERLAP NATURALLY, PLACE 3 in (7.5 cm) OF ROCK OR INFILL SOIL BETWEEN THE OVERLAPPING LAYERS (CHAPTER 7.2)
  - 7-5 WHEN GRID FANS APART, PLACE A SECONDARY, EQUAL LENGTH LAYER OF GRID ON THE NEXT COURSE ABOVE TO SPAN THE GAP (CHAPTER 7.2)
- \* SEE BEST PRACTICES DOCUMENT CHAPTER 7.0 FOR MORE GEOGRID NOTES

**OUTSIDE CURVE**

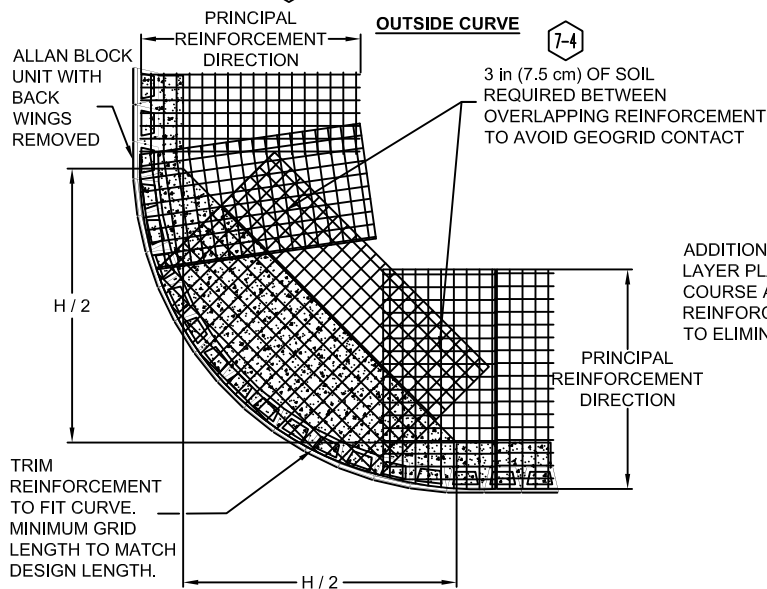

**INSIDE CURVE**

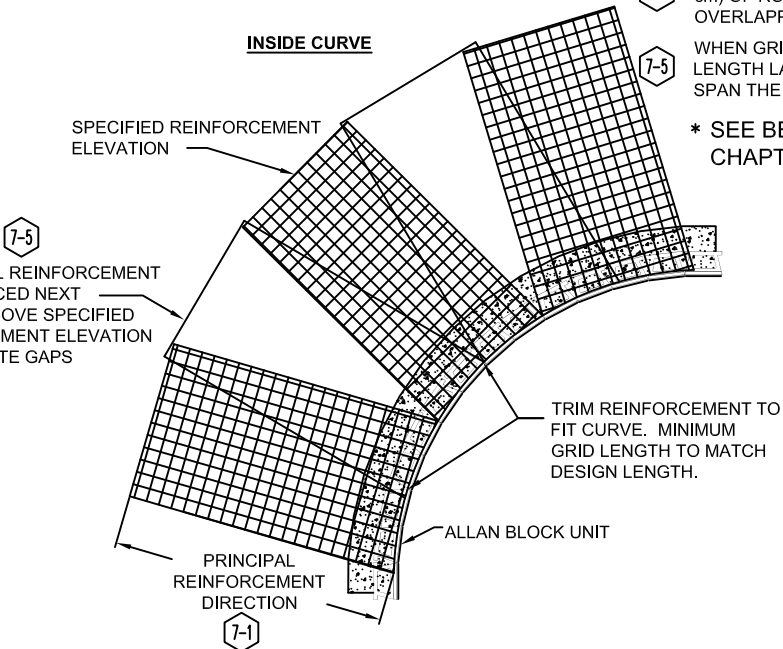

Designed By:  
KAH

Title:

**BEST PRACTICES GEOGRID**

Date:  
09/02/2015

Checked By:  
RJL



This drawing should not be used for final design or construction without the certification of a professional engineer registered in the state in which the wall will be built. The accuracy and use of details contained in this document are the sole responsibility of the user. The user must verify each detail for accuracy as they pertain to their particular project.  
© 2005 Allan Block

Project No:  
I099.14

Scale:  
NOT TO SCALE

Drawing No:  
6